

dōTERRA® pilot™ MAX

派樂之家芳香噴霧器

使用說明書

vi

產品結構

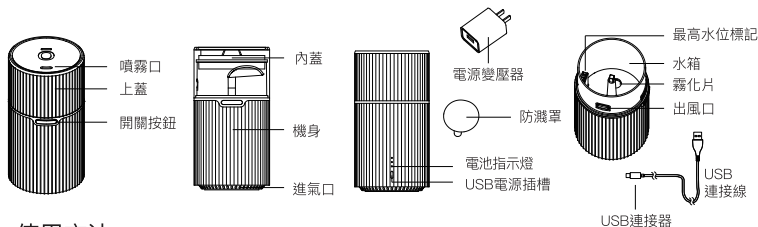

使用方法

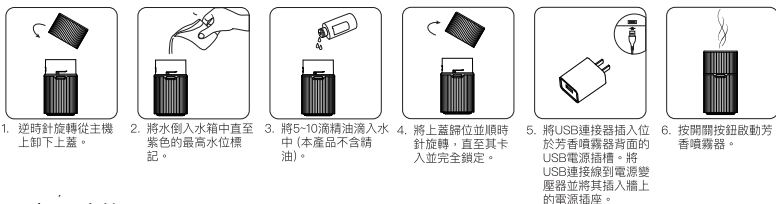

產品功能

持續噴霧模式

第一次按下開關按鈕=白光/連續噴霧模式
第二次按下開關按鈕=燈關閉/連續噴霧模式
第三次按下開關按鈕=關機

噴霧模式設置

- 在連續噴霧模式下，長按開關按鈕1.5秒鐘以上，可切換至間歇模式（5分鐘開/5分鐘關）。藍燈閃爍兩次以確認是否啟動間歇模式。
- 在間歇噴霧模式下，長按開關按鈕1.5秒鐘以上，可切換到連續噴霧模式。紫色指示燈閃爍兩次，以確認是否啟動連續噴霧模式。
- 在噴霧模式之間切換時會保留所選的燈光設置。

大霧量模式

- 在連續噴霧模式下，雙擊開關按鈕切換到大霧量模式。在大霧量模式期間，青色燈會亮起並保持亮起。大霧量模式將以更高的霧量運作，直到水位降至過低水平。
- 如要退出大霧量模式，請再次按下開關按鈕關閉噴霧器。

*注意事項：

- 水位警報：當水位過低時，紅燈閃爍兩次，噴霧將自動關閉。
- 電池電量耗盡保護：使用電池電源時，如果電池電量過低，本設備將自動徹底關閉，並且紅燈閃爍三次。
- 外部電源過低/高警報：當連接的USB電源的電壓過低或過高時，紅燈閃爍十次，並且本設備將自動徹底關閉。

電池指示燈

不充電時：當按下開關按鈕時，電池指示燈亮起 10 秒。

1. 電池電量 ≤ 30%：
• 第一個指示燈閃爍。



2. 電池電量在 30% 到 60% 之間：
• 第一個指示燈亮起



3. 電池電量在 60% 到 90% 之間：
• 第一和第二指示燈亮起



4. 電池電量 90% 以上：
• 第一、第二和第三指示燈亮起。



充電時：按下開關按鈕時或當USB電纜插入或拔出時，電池指示燈亮10秒。

1. 電池電量 ≤ 30%：
• 第一個指示燈閃爍。



2. 電池電量在 30% 到 60% 之間：
• 第一個指示燈亮起
• 第二個指示燈閃爍



3. 電池電量在 60% 到 90% 之間：
• 第一和第二指示燈亮起
• 第三個指示燈閃爍



4. 電池電量 90% 以上：
• 第一、第二和第三指示燈亮起。



使用2安培電源變壓器從電量耗盡到充滿電大約需要 4-5 小時。

重要事項：與大多數離子電池一樣，設備的電池壽命將隨著時間的流逝逐漸減少。

與新設備上的電池相比，約300個充電週期後，設備的電池壽命將減少到約80%。這是正常現象，並不表示設備或電池有問題。

注意事項

- 噴霧量多寡會因水質、精油及空氣溫度而有所不同。此為正常狀況。
- 此產品為使用純天然精油而設計的。化學香精、香料或不純精油可能會對產品造成損壞。
- 請於每次使用後進行清潔。使用自來水、泉水或蒸餾水進行清潔與乾淨毛巾擦拭。
- 若水位過低時噴霧器會自動關閉。

清潔和保養



排空水箱時，請從出風口的另一側倒水。

清潔之前，請關閉設備電源並拔下電源變壓器。排空水箱時，請從出風口的另一側倒水。

每周至少用棉布和溫水清潔水箱和霧化片兩次。

警告：使用腐蝕性或刺激性化學物質可能會對設備造成損壞。精油不應與芳香噴霧器的機身表面接觸。

產品保證書

dōTERRA提供一年保養，保養條款內容如下：

dōTERRA Hong Kong Ltd. (以下簡稱dōTERRA)

提供產品從顧客購買日起一年內，在嚴格遵循產品使用說明之操作與保養情況下，為其購買產品之材料及製造的瑕疵提供保養。若產品於保養期限內發生故障者本公司接受申請，dōTERRA依規定可選擇 (1) 提供原顧客新的替換品或 (2) 依照dōTERRA 30天退換貨政策退款。

新品寄出或退款前，請先將故障產品寄回dōTERRA，產品一經替換，回收之產品將視為dōTERRA之財產。

詳細資訊請洽消費者服務專線：(852) 3197-6699

安全須知

- 務必按指示使用
 - 請務必使用裝置附設的USB線與電源變壓器
 - 請勿將水從出口倒出
 - 若需移動裝置並收放，請務必關閉電源並拔出插頭，將水箱清空並清洗乾淨
 - 若有燒焦味，請務必立即關閉電源
 - 請勿將水裝超過最高水位標記
 - 請將裝置放於平坦平面上，而非凹凸不平的地方如地毯
 - 可加入自來水，不建議使用礦泉水
 - 使用機器時請勿移動裝置，將插頭拔出時，請從變壓器端拔起，勿直接拉扯USB線
 - 請勿在靠近水的地方使用本產品
 - 勿將機器放於可太陽直射或接近冰箱、電風扇、高溫處
 - 若無成人監護，請勿由兒童操作本產品
 - 裝置並非醫療使用
- 切勿直接吸入煙霧

故障排除指南

情況	可能原因	可能原因
無法開啟噴霧器/未到時間自行關閉	1. 水箱內儲水量不足 2. 電源連接不當 3. 電池未充電	1.向水箱加水直至最高水位標記。 2.拔除電源再重新啟動。 3.對電池進行充電。
沒有噴霧或噴霧異常	水位超過最高水位標記 (噴霧故障，但燈光正常)	1.確保水位不超過紫色的最高水位標記 2.確保加入的水是自來水或泉水。
	沒有空氣通過進氣口	1.進氣口可能被阻塞。檢查以確保進氣口無異物阻塞，並且設備被放置在固體表面上。 2.檢查風扇狀況。如果異常，請電洽消費者服務專線：(04)22107105。
	1. 霧化片有油污 2. 噴霧器底部的進氣口被堵塞	1.請遵循有關清潔和保養的說明指示。 2.進氣口堵塞可能會影響霧化性能。
漏水	1. 上蓋未鎖定或未蓋緊。 2. 溫度過低/過高或濕度過高 3. 有水溢出 4. 未安裝防護罩	1.更換或調整頂蓋可以解決此問題。 2.調節室溫或濕度。 3.徹底擦拭噴霧器並確保設備保持乾燥狀態。然後重新啟動設備。 4.重新安裝防護罩。

產品規格

1. 尺寸：直徑88mm*165mm
2. 材質：PP與麥稈
3. 水箱容量：120毫升
4. 適用面積：300 平方英尺(10坪以下空間)
5. 連續噴霧使用時間：長達6小時
6. 間歇噴霧使用時間（5分鐘開/5分鐘關）：長達12小時
7. 可調控開/關的明亮暖光
8. 自動安全關機
9. 電源：DC 5V 2A和 3.7 V 7800mAh 電池



此設備不適用於聽能、感官或精神功能不全或缺乏生活經驗和常識者（包括兒童）使用，除非負責他們安全的人士為他們提供看護或有關設備使用的指導。請看護好兒童以免他們把玩此設備。

8歲及以上兒童和聽能、感官或精神功能不全或缺乏生活經驗和常識者可以使用此設備，前提是他們在相關看護下使用或得到安全使用設備的相關指導，並理解可能涉及的危險。兒童不可把玩此設備。無人看護的兒童不可進行清理和維護工作。

CAN ICES-1/NMB-1
本ISM裝置符合加拿大ICES-001輻射限制。

- 本裝置符合美國聯邦通信委員會 (FCC) 規則第18部分規定
- (a) 電器或系統潛在的電磁輻射干擾：本裝置運作時應有下列兩種情形：
- (1) 本裝置不會造成有害干擾；
 - (2) 本裝置必須承受任何接收到的干擾，包括可能造成裝置異常運作的干擾。
- (b) 系統維護
安全注意事項：關於本產品負責方明確批准，擅自變更或修改本裝置會導致使用者無法使用本產品。
- (c) 用戶改善乾擾可採取的簡易方式：
- 注意：本裝置產生、使用並可能輻射無線射頻能量，如果不按照指示安裝與使用，則可能會對無線電通訊造成有害干擾。然而，按照指示安裝並不能保證某些安裝不會發生干擾。如果本裝置確實對無線電或電視接收造成有害干擾（可透過關閉和開啟本裝置來確定），使用者可嘗試採取以下一種或多種措施來改善干擾：
- 調整接收天線的方向或位置。
 - 擴大本裝置和接收器的間距。
 - 將本裝置和接收器電源線插入不同線路的插座。
 - 請諮詢經銷商或有經驗的無線電/電視技術人員優先協助。

產品型號: BY-PD09
委製商: doTERRA Int'l, LLC
389 S 1300 W, Pleasant Grove, UT 84062 USA



dōTERRA® pilōt™ | MAX

Ultrasonic Diffuser

Instruction Manual

vi

Overview

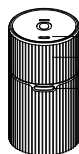

Mist Outlet
Top Cover
ON/ OFF
Button

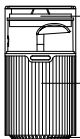

Inner Lid
Main Body
Air Inlet

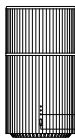

Adapter



Splash Guard

Battery Indicator

USB Power Socket

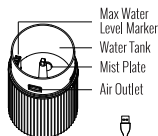

Max Water
Level Marker

Water Tank

Mist Plate

Air Outlet

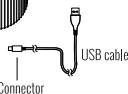

USB Connector

Instructions for Use



1. Rotate counter clockwise to remove the Top Cover from the Main Body.

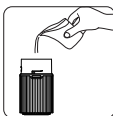

2. Pour water into the Water Tank up to the purple Max Water Level Marker.



3. Add 5-10 drops of essential oil (not included) directly into the Water Tank.

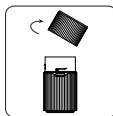

4. Replace Top Cover and rotate clockwise until it clicks and locks completely.

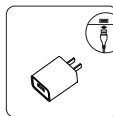

5. Insert the USB Cable Connector into the USB Power Socket located on the back of the diffuser. Connect the USB Cable to the Adapter and plug the Adapter into an electrical wall outlet.



6. Press the ON/OFF Button to start the diffuser.

Functions

Continuous Mist Mode

1st press ON/OFF Button = White light, Continuous Mist Mode
2nd press ON/OFF Button = Light Off, Continuous Mist Mode
3rd press ON/OFF Button = Power Off

Ultra Mist Mode

1. In the Continuous Mist Mode, double click on the ON/OFF Button to switch to Ultra Mist Mode. Cyan light turns ON and remains ON during Ultra Mist Mode. The Ultramist Mist Mode will mist at a higher mist volume until water level becomes too low.
2. To exit Ultra Mist Mode, press the ON/OFF Button again to turn off the diffuser.

Mist Mode Setting

1. In the Continuous Mist Mode, long press the ON/OFF Button for over 1.5 seconds to switch to Intermittent Mode (5 minutes ON/ 5 minutes OFF). Blue light flashes twice to confirm Intermittent Mode.
2. In the Intermittent Mist Mode, long press on the ON/OFF Button for over 1.5 seconds to switch to Continuous Mist Mode. Purple light flashes twice to confirm Continuous Mist Mode.
3. The selected light setting is retained when switching between the mist modes.

*Note:

1. Water Level Alert: When water level becomes too low, red light flashes twice and the mist will automatically shut off.
2. Battery Drained Protection: When working on battery, when the battery power becomes too low, the diffuser will automatically shut off completely and red light flashes three times.
3. External Power Low/High Alarm: When the voltage of the connected USB power is too low or too high, the red light flashes 10 times and the diffuser will automatically shut off completely.

Battery Indicator

When not charging: Battery Indicators light up for 10 seconds when ON/OFF Button is pressed.

1. Battery power less than or equal to 30%:
• 1st Indicator flashes.



2. Battery power between 30% and 60%:
• 1st Indicator ON.



3. Battery power between 60% and 90%:
• 1st and 2nd Indicator ON



4. Battery power is more than 90%:
• 1st, 2nd and 3rd Indicator ON.



When charging: Battery Indicators light up for 10 seconds when ON/OFF Button is pressed or when USB cable is plugged-in or unplugged.

1. Battery power less than or equal to 30%:
• 1st Indicator flashes



2. Battery power between 30% and 60%:
• 1st Indicator ON
• 2nd Indicator flashes



3. Battery power between 60% and 90%:
• 1st and 2nd Indicator ON
• 3rd Indicator flashes



4. Battery power is more than 90%:
• 1st, 2nd and 3rd Indicator ON.



Charging time is approximately 4-5 hours from drained to full charge with 2Amp Power Adapter.

Important: As with most lithium-ion batteries, the diffuser battery life will gradually decrease over time. After about 300 charge cycles, the diffuser battery life will decrease to about 80 percent compared to the battery on a new diffuser. This is normal and does not represent an issue with the diffuser or with the battery.

Cleaning and Maintenance



When emptying the Water Tank, pour water from the opposite side of the Air Outlet.

Before cleaning, turn off the diffuser and unplug the Adapter. When emptying the Water Tank, pour water from the opposite side of the Air Outlet.

Clean the Mist Plate in the Water Tank with a cotton cloth and warm water at least twice a week.

Warning: Use of corrosive or harsh chemicals may cause damage. Essential oil should not come in contact with the exterior surface of the diffuser.

Product specifications

1. Dimension: 88mm x 88mm x 165mm / 3.5in x 3.5in x 6.5in
2. Material: PP-Straw
3. Water Capacity: 120 mL / 4.06 fl oz
4. Suggested Room Size: 300Sq.ft/30Sq.m
5. Continuous Operation: Up to 6 hours
6. Intermittent Operation: Up to 12 hours
7. Bright warm ambient light on and off
8. Automatic safety shut-off
9. Power Source: DC5V 2A and 3.7V 7800mAh battery

Troubleshooting

Status	Cause(s)	Solution(s)
Startup Failure/Early Shutdown	1. Insufficient water 2. Improper power cable connection 3. Battery not charged	1. Fill water to the Max Water Level Marker. 2. Unplug the USB Cable and reset carefully. 3. Charge the battery.
No mist or abnormal mist	Water level exceeds the Maximum Water Level marker(Misting failure but normal light)	1. Make sure the water level does not exceed the Purple Max Water Level Marker. 2. Ensure that tap water or spring water is added.
	No air flows through the Air Inlet	1. The Air Inlet may be blocked. Check to make sure there is nothing blocking the inlet and that the device is placed on a hard surface. 2. Check the fan condition. If it is abnormal, please call doTERRA.
	1. Oil contamination on Mist Plate 2. Air Inlet at the bottom of the diffuser is blocked	1. Please follow the instructions on cleaning and maintenance. 2. Blockage to the Air Inlet may influence the misting performance.
Water Leakage	1. Top Cover is not locked or missing 2. Temperature too low or too high/high humidity 3. Water spillage 4. Splash Guard is not installed	1. Replacing or adjusting the Top Cover may resolve the problem. 2. Adjust the room temperature or humidity. 3. Wipe the diffuser thoroughly and ensure the diffuser is dry. Then restart the diffuser. 4. Reinstall the Splash Guard.

Safety

1. Only use the diffuser for the intended purpose.
2. Use only the USB Cable and Adapter included in the package.
3. Do not drain the water from the Air Outlet.
4. When storing the diffuser or relocating it, turn the power off, unplug the diffuser, empty the Water Tank and clean the product.
5. Turn off the diffuser immediately if there is any smoke or burning smell.
6. Do not exceed the Max Water Level Marker.
7. Place the diffuser on a flat and solid surface instead of uneven and/or unstable ones like carpets or rugs etc.
8. Refill with tap water, spring water, or distilled water. Do not use mineral water.
9. Do not move the diffuser during its operation. Pull the Adapter instead of the cord to unplug.
10. Do not use this appliance near water.
11. Do not place the diffuser in direct sunlight or close to a refrigerator, a fan, or other hot environment.
12. This diffuser should not be operated by children unless supervised by an adult.
13. This diffuser is not meant for medical purposes.

DO NOT inhale the vapor directly from the Mist Outlet.

Product Warranty

dōTERRA® One (1) Year Limited Warranty. dōTERRA's warranty obligation for this product is limited to the terms set forth below:

dōTERRA Hong Kong Ltd. ("dōTERRA") warrants this diffuser against defects in materials and workmanship under normal use for a period of ONE (1) YEAR from the date of purchase by the original end-user purchaser ("Warranty Period") provided the operation and maintenance strictly follow the instruction manual. If a defect arises and a valid claim is received within the Warranty Period, at its option and to the extent permitted by law, dōTERRA will either (1) ship a new replacement diffuser to original end-user, or (2) issue a refund based on the dōTERRA 30-day return policy. When a replacement or refund is given, the diffuser for which the replacement or refund is provided must be returned to dōTERRA prior to replacement or refund and becomes dōTERRA's property.

Please call (852) 3197-6699 for more information.

Cautions

1. It is normal for mist volume to vary with the type of water and essential oil used, humidity, and/or air temperature.
2. The diffuser is designed for using pure, natural essential oil, Chemical fragrance, spice, or impure essential oil used may cause product damage.
3. Clean the diffuser after each use. Use tap water, spring water or distilled water for washing and a soft cloth for wiping.
4. The diffuser will turn off automatically when the water level becomes too low.



This appliance is not intended for use by persons (including children) with reduced physical, sensory or mental capabilities, or lack of experience and knowledge, unless they have been given supervision or instruction concerning use of the appliance by a person responsible for their safety. Children should be supervised to ensure that they do not play with the appliance.

This appliance can be used by children ages 8 years and above and persons with reduced physical, sensory or mental capabilities if they have been given supervision or instruction concerning use of the appliance in a safe way and understand the hazards involved. Children should not play with the appliance. Cleaning and user maintenance should not be made by children without supervision.

CAN ICES-1/NMB-1

This ISM device complies with Canadian ICES-001

This device complies with part 18 of the FCC Rules

(a) The interference potential of device or system:

Operation is subject to the following two conditions:

(1) This device may not cause harmful interference, and

(2) this device must accept any interference received, including interference that may cause undesired operation.

(b) Maintenance of the system:

CAUTION: Changes or modifications not expressly approved by the party responsible for compliance could void the user's authority to operate the product.

(c) Simple measures that can be taken by the user to correct interference:

NOTE: This equipment generates, uses and can radiate radio frequency energy and, if not installed and used in accordance with the instructions, may cause harmful interference to radio communications. However, there is no guarantee that interference will not occur in a particular installation. If this equipment does cause harmful interference to radio or television reception, which can be determined by turning the equipment off and on, the user is encouraged to try to correct the interference by one or more of the following measures:

- Reorient or relocate the receiving antenna.
- Increase the separation between the equipment and receiver.
- Connect the equipment into an outlet on a circuit different from that to which the receiver is connected.
- Consult the dealer or an experienced radio/TV technician for help.

model number: BY-PD09

Manufactured for: **dōTERRA Int'l, LLC**
389 S 1300 W, Pleasant Grove, UT 84062 USA